

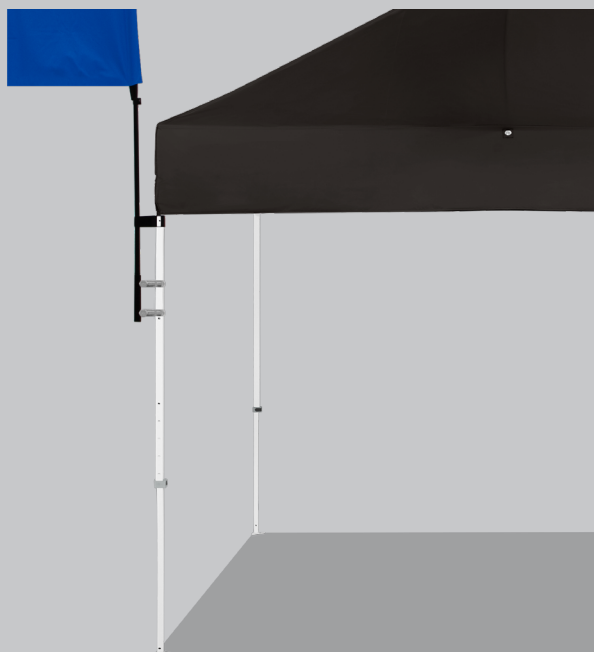

# FLAG CANOPY MOUNT



CANOPY NOT INCLUDED

Easily attach your E-Z UP® ProFlag directly to the leg with this Flag Canopy Mount. Elevate your message or brand to a greater visibility level beyond standard flag heights

Part of the customizable E-Z Event System™ designed to optimize your canopy setup.

E-Z Brackets (Patent Pending) are versatile attachments that allow you to customize your canopy according to your event.

## FEATURES

- Attaches to Canopy with E-Z Brackets (Patent Pending)
- Position at Any Height on Canopy Leg for Your Ideal Setup
- Rubber Pads Ensure Brackets Stay Secure and Prevent Slipping
- Easy to Use Thumb Screws - No Tools Needed for Installation
- Compatible with Eclipse™, Eclipse™ HUT, Eclipse™ MAX, Endeavor™, Endeavor™ HUB, Endeavor™ MAX, Endeavor™ USA, ES100S™, Express™, Hi-Viz®, Patriot™, Pyramid™, Speed Shelter®, Vantage™, VUE™
- Corner Flags Need Adapter (Sold Separately)
- Canopy Not Included
- Includes: (1) Mount, (1) Hook & Loop Strap, (2) E-Z Brackets

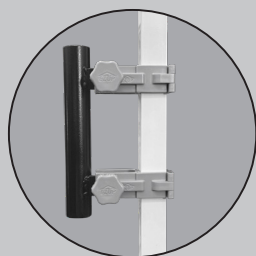
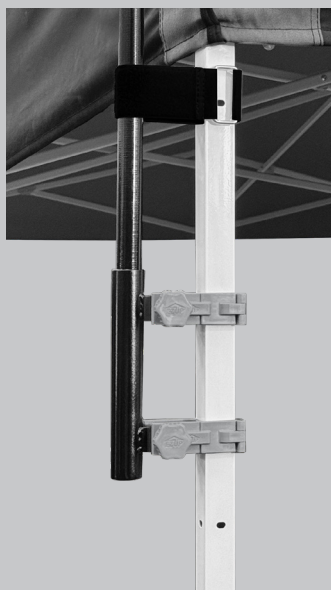

PRODUCT DIMENSIONS	2.8" L x 1.3" W x 8" H (7 cm x 3 cm x 20 cm)
ITEM WEIGHT	1 lb (0.5 kg)
SHIPPING DIMENSIONS	9" L x 6" W x 1.5" H (23 cm x 15 cm x 4 cm)
SHIPPING WEIGHT	1.1 lbs (0.5 kg)
WARRANTY	1 Year

**International E-Z UP, Inc.**  
1900 Second Street  
Norco, California 92860  
(951) 279-0999 • FAX (800) 810-8775

TO ORDER:  
**(800) 45-SHADE**  
(800) 457-4233