



INSTRUCTIONS FOR

**FREEDOM83™**

## WHAT'S IN THE BOXES

Your Freedom83™ Top Box Includes: (1) Fabric Top and (1) Cover Bag

Your Freedom83™ Frame Box Includes: (1) Folding Frame

## ONE-TIME TOP INSTALLATION

### Unpack and Open

1. Place your E-Z UP® Frame in the center of the area to be sheltered.
2. With a partner on the opposite side of the Frame, grasp two outer legs, lift the Frame slightly off the ground, and step backwards while pulling the Frame to open. (Fig A)
3. Stop when the Frame is approximately 1/2 of its fully-opened size.
4. Set the Frame back on the ground.

### Attach Fabric Top

5. Gently unfold the Fabric Top, and place it over the semi-opened Frame. (Fig B)
6. Attach the Fabric Top to the E-Z UP® Frame by matching the Hook and Loop strips on the inside of the Fabric Top corners with the Hook and Loop strips on each Frame corner. (Fig C)
7. Pull the Fabric Top down over the Frame corners — pushing the Hook and Loop strips firmly together.

### Secure Top to Frame

8. Line up the grommet holes on the sides of the Fabric Top to the Frame top attachment points. The top attachment points on the Frame are denoted by the RED tags. (Fig D)
9. Using a coin, unscrew the Top Attachment Nut from the frame bolt. (Fig E)
10. Place Fabric Top grommet on the Frame bolt.
11. Screw on top attachment nut and tighten until snug. Top Fabric should rotate easily. Do not over-tighten.
12. Repeat this procedure at each of the top attachment points.

*Note: Hold the bolt assembly with one hand while tightening the top attachment nut with your other hand.*

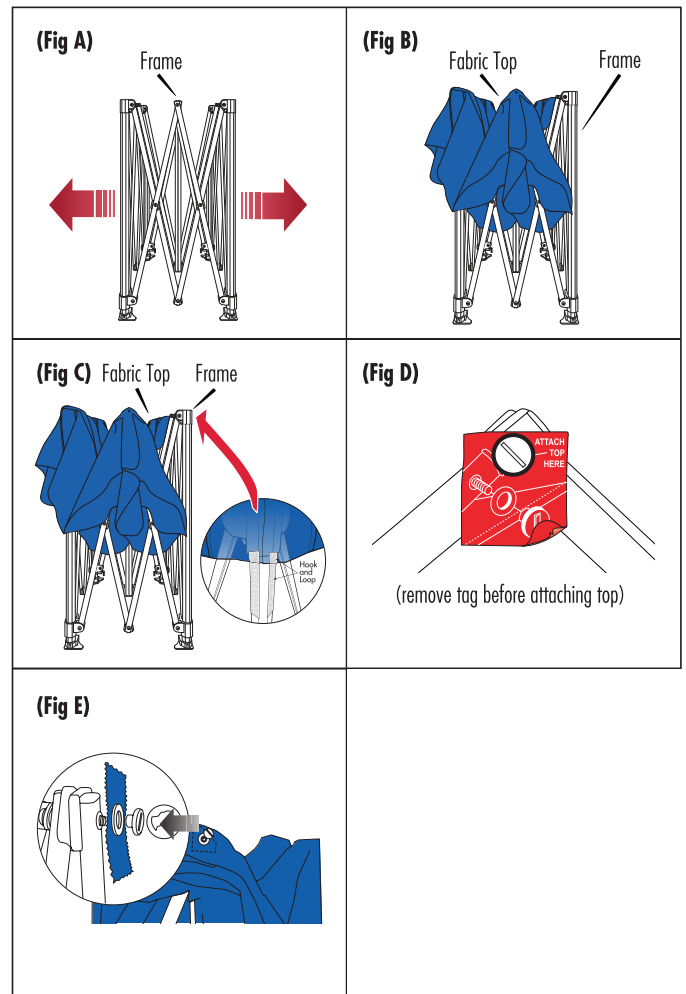

INTERNATIONAL E-Z UP, INC.  
1900 Second St., Norco, California 92860

800-45-SHADE

The #1 Instant Shelter® Brand in the World

ezup.com



## INSTRUCTIONS FOR

# FREEDOM83™

## SET UP

### Open E-Z UP® Shelter

1. With a partner on the opposite side, grasp the bottom of the diamond-shaped area of outer trusses near the "OPEN HERE" sticker. **(Fig A)**
2. Lift the **Frame** up slightly and step backward until the shelter is almost fully opened. Gently shake the shelter while opening. Be careful not to pinch fingers!

### Secure Auto-Slider® Pull Pin

3. Fold up the **Fabric Top** corner to expose the Auto-Slider® Pull Pin. **(Fig B)**
4. Lift shelter corner slightly off the ground and engage the Auto-Slider® Pull Pin by pushing up on the **Frame** side trusses with one hand while holding down the top of the **Frame** leg with the other hand. The pins will auto-engage when aligned with the holes on the frame legs.
5. After the Auto-Slider® Pull Pin has locked into place, pull the **Fabric Top** down over the frame leg, making sure to align and secure the hook and loop strips on the **Fabric Top** to the **Frame**.

Repeat on all remaining corners.

### Extend & Secure Frame Legs

6. With a partner, lift the two adjacent outer legs up off the ground simultaneously to about waist height.
7. Slide the lower/inner legs out until the leg adjustment toggle buttons lock at selected height on each leg. **(Fig C)**
8. Lower middle leg until the toggle button locks.
9. Repeat on the remaining legs.

*Note: It is recommended that you use genuine E-Z UP® Deluxe Weight Bags and/or Heavy-Duty Stake Kits to secure your shelter.*

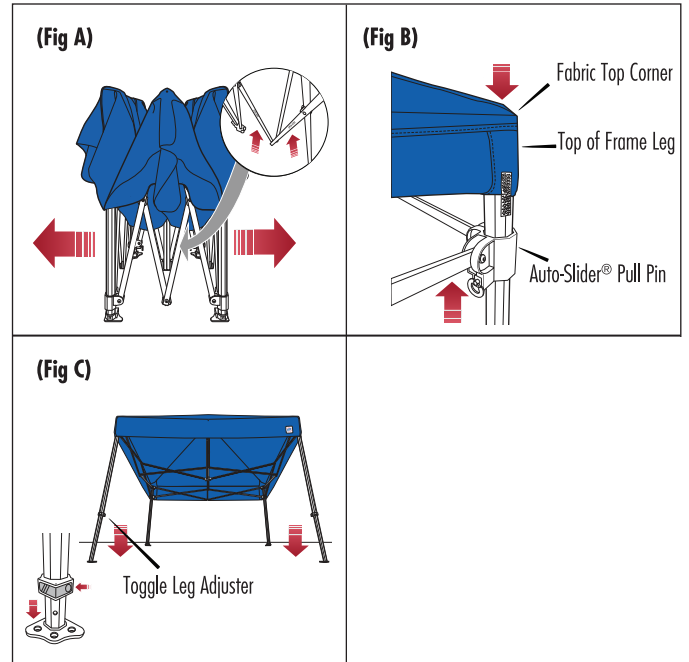



INSTRUCTIONS FOR

**FREEDOM83™**

## TAKE DOWN

1. With a partner, slightly lift two adjacent corner legs simultaneously. (Fig A)
2. Depress the toggle button and slide lower/inner legs into upper/outer legs, making sure to do two legs at a time on the same side.
3. Repeat on remaining legs.

*Note: Keep the toggle button depressed while retracting leg.*

### Release Auto-Slider® Pull Pin

4. With one hand, slightly push up on the truss near the Auto-Slider® Pull Pin to relieve pressure. (Fig B)
5. With the other hand, release the Auto-Slider® Pull Pin by pulling the ring.
6. Repeat on remaining legs.

### Closing Shelter

7. Grasp the **Frame** on the top of the diamond-shaped area of center outer trusses on the opposite sides near the "CLOSE HERE" sticker. (Fig C)
8. Lift the shelter up slightly, and shake it while stepping toward your partner until the shelter is approximately 3/4 closed. Be careful not to pinch fingers!
9. Grasp the two outer legs, and push the frame together until it is fully closed.
10. Store the shelter in the cover bag provided.

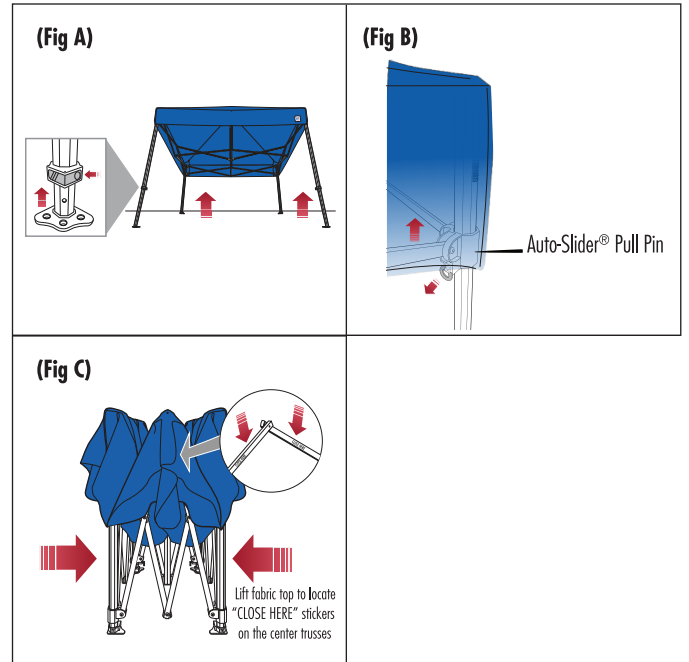

## CARE AND MAINTENANCE

For long lasting durability and the best possible protection for your E-Z UP® Instant Shelter® products, follow these E-Z care and maintenance instructions:

- Use a mild soap (not detergent) and plenty of water for the top cleaning.
- Let the E-Z UP® top and frame dry completely before closing or storing to avoid mildew.
- Frame will operate and look better if occasionally treated with silicone spray, especially before and after use in damp conditions. Remove excess silicone residue before applying top.
- Use a seam sealer (available at most sporting goods and hardware stores) if top leaks or drips water.
- Slightly tighten bolts if frame becomes loose.

### Replacement Parts

Call 800-45-SHADE or visit [ezup.com/parts](http://ezup.com/parts)



INTERNATIONAL E-Z UP, INC.  
1900 Second St., Norco, California 92860

800-45-SHADE

The #1 Instant Shelter® Brand in the World

[ezup.com](http://ezup.com)



INSTRUCTIONS FOR

**FREEDOM83™**

## IMPORTANT INFORMATION

**Read this information before proceeding. It is the user's responsibility to take the following precautions at all times.**

- Always stake or weigh down your E-Z UP® Instant Shelter® product with genuine E-Z UP® accessories. Do not use in any potentially windy or rainy weather.
- Wind and rain can damage the E-Z UP® Instant Shelter® product and also may result in injury to you or others. Therefore, do not rely on your shelter for protection in heavy or prolonged rain storms. The E-Z UP® Instant Shelter® product is designed as a temporary shelter. Do not leave it up for extended periods.
- Do not use shelter in a lightning storm.
- Do not leave your E-Z UP® Instant Shelter® product unattended.

### WARNING:

Keep all flame and heat sources away from all Instant Shelter® fabrics and accessories. These fabrics meet the flammability requirements of CPAI-84. The fabric may burn if left in continuous contact with any flame source. The application of any foreign substance to the fabric may render the flame-resistant properties ineffective.

CPAI-84, NFP-701, CAN/ULC-S109 & CA STATE FIRE MARSHALL CERTIFIED

## PRODUCT WARRANTY

INTERNATIONAL E-Z UP, INC., manufacturer of E-Z UP® Instant Shelter® products, warrants to the original purchaser who provides a dated sales receipt, from an authorized seller, each part of the E-Z UP® Instant Shelter® product to be free from defects in material or workmanship for a period of SEVEN YEARS after the date of original purchase. This warranty applies only for normal and expected uses, as determined by the manufacturer. INTERNATIONAL E-Z UP, INC.'s obligation and liability under this warranty is limited to the repair or replacement (at its option) of the product or its parts, after its own review and examination.

## WARRANTY RETURN ADVISORY

Before returning any item to INTERNATIONAL E-Z UP, INC. or its designated representative, please obtain specific warranty return shipping instructions by submitting a Warranty Claim Form online at [ezup.com/warranties](http://ezup.com/warranties) or call 800-45-SHADE. All shipping costs must be prepaid, and INTERNATIONAL E-Z UP, INC. is not responsible for products damaged in transit.

## CONDITIONS

This warranty shall be void as to any product that has been altered or modified in any manner. This warranty does not apply to damages caused by wind, rain, or other forces of nature, not to accidental or deliberate damage of the product, nor to the use of the product that does not conform with the product instructions. This warranty is provided in lieu of all other warranties, expressed or implied.



INTERNATIONAL E-Z UP, INC.  
1900 Second St., Norco, California 92860

800-45-SHADE

The #1 Instant Shelter® Brand in the World

[ezup.com](http://ezup.com)